

# New Trimming Nozzles CM-F series

Single-orifice type  
Dual-orifice type

## Single-orifice type [CM-F]

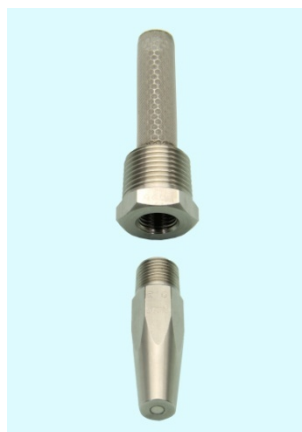

### [FEATURES]

- Clear, non-turbulent solid stream.
- Small, tapered nose minimizes paper dust adhesion to nozzle body.
- Flat surface design of nozzle tip prevents paper dust from clogging spray orifice.

### [DRAWINGS]

Complete unit

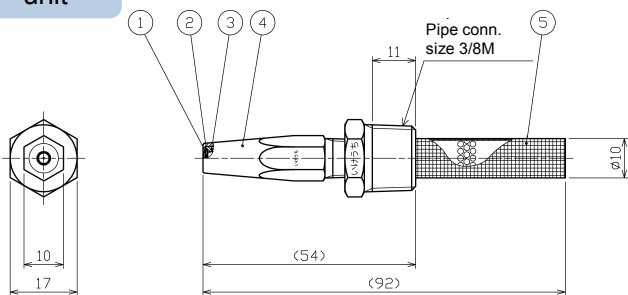

Nozzle only

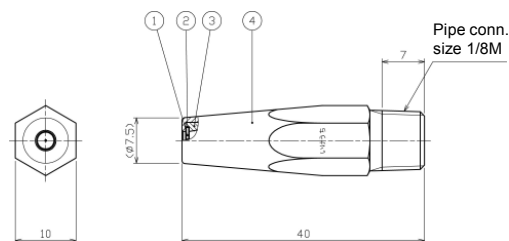

① Nozzle orifice ② Adhesive ③ Sleeve ④ Body ⑤ Strainer

### [MATERIALS]

- Nozzle tip (orifice): Alumina 99%
- Sleeve, Body, and Strainer: Stainless steel

### [MASS]

- Nozzle only: 15 g
- Complete unit: 38 g

[Note] Appearance and dimensions may differ slightly depending on materials and nozzle codes.

Orifice Diameter Code	Spray Capacity (L/min)						Strainer Mesh Size
	0.5MPa	1MPa	2MPa	3MPa	4MPa	5MPa	
φ 0.3F	0.10	0.14	0.19	0.23	0.27	0.30	150
φ 0.4F	0.17	0.24	0.34	0.41	0.47	0.52	150
φ 0.5F	0.25	0.35	0.49	0.60	0.68	0.76	80
φ 0.6F	0.36	0.51	0.71	0.86	0.99	1.10	80
φ 0.7F	0.49	0.69	0.96	1.17	1.34	1.49	50
φ 0.8F	0.65	0.90	1.26	1.53	1.75	1.95	50
φ 0.9F	0.78	1.09	1.52	1.84	2.11	2.35	50
φ 1.0F	0.97	1.34	1.88	2.28	2.61	2.91	50

How to order: Please inquire or order for a specific nozzle using this coding system.

#### ■ Complete unit

[Example] 3/8M CM φ 0.4F S303W

3/8M CM φ 0.4 F S303W

Orifice Diameter Code

■ φ 0.3F - φ 1.0F

#### ■ Nozzle only

[Example] 1/8M CMP φ 0.4F S303

1/8M CMP φ 0.4 F S303

Orifice Diameter Code

■ φ 0.3F - φ 1.0F



"The Fog Engineers"

H. IKEUCHI & CO., LTD.

# Dual-orifice type [2CM-F]



## 【FEATURES】

- Two clear, non-turbulent solid streams.
- Includes the nozzle cover, which protects spray orifice from paper dust.
- Spray orifice position can be adjusted manually.
- Nozzle body is coated with PTFE for preventing paper dust accumulation.

## 【DRAWINGS】

### Complete unit

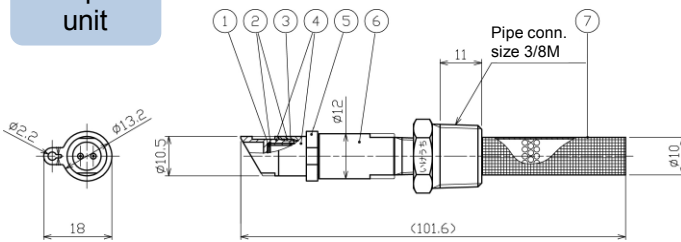

### Nozzle only

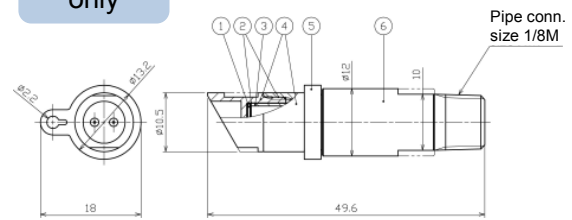

① Nozzle tip (orifice) ② Adhesive ③ Sleeve ④ Body ⑤ Grip ⑥ Adaptor ⑦ Strainer

## 【MATERIALS】

- Nozzle tip (orifice): Alumina 99%
- Sleeve, Body, Grip, and Strainer: Stainless steel
- \*Nozzle outer surface is coated with PTFE.

## 【MASS】

- Nozzle only: 22 g
- Complete unit: 45 g

[Note] Appearance and dimensions may differ slightly depending on materials and nozzle codes.

Orifice Diameter Code	Spray Capacity (L/min)				Strainer Mesh Size
	0.5MPa	1MPa	2MPa	3MPa	
φ 0.4F	0.31	0.43	0.61	0.74	150
φ 0.5F	0.45	0.63	0.88	1.08	80

How to order: Please inquire or order for a specific nozzle using this coding system.

### ■ Complete unit

[Example] 3/8M 2CM φ 0.4F S303W

3/8M 2CM φ 0.4 F S303W

Orifice Diameter

- φ 0.4F
- φ 0.5F

### ■ Nozzle only

[Example] 1/8M 2CMP φ 0.4F S303

1/8M 2CMP φ 0.4 F S303

Orifice Diameter Code

- φ 0.4F
- φ 0.5F

For details or any inquiry please feel free to contact our sales office or mail us at [overseas@kirinoikeuchi.co.jp](mailto:overseas@kirinoikeuchi.co.jp).

 "The Fog Engineers"  
**H. IKEUCHI & CO., LTD.**

### Headquarters

Daiichi Kyogyo Bldg., 1-15-15, Awaza  
Nishi-ku, Osaka 550-0011, Japan  
Tel: 81-6-6538-4015 Fax: 81-6-6538-4022  
E-mail: [overseas@kirinoikeuchi.co.jp](mailto:overseas@kirinoikeuchi.co.jp)  
URL: <http://www.kirinoikeuchi.co.jp/eng/>

### IKEUCHI (SHANGHAI) CO., LTD.

Room C, 21/F, Electrical & Mechanical Bldg., 600 Hengfeng Road, Shanghai 200070, P.R.China  
Tel: 86-21-6140-9731 Fax: 86-21-6123-4239 [mist@kirinoikeuchi.com](mailto:mist@kirinoikeuchi.com) <http://www.kirinoikeuchi.com>  
Tianjin Branch Tel: 86-22-2320-1676 Fax: 86-22-2320-1675  
Shenzhen Branch Tel: 86-755-8525-2221 Fax: 86-755-8525-2215

### IKEUCHI USA, INC.

8110 Beckett Center Drive, West Chester, OH 45069 USA  
Tel: 1-513-942-3060 Fax: 1-513-942-3064 [info@ikeuchiusa.com](mailto:info@ikeuchiusa.com) <http://www.ikeuchiusa.com/>

### IKEUCHI EUROPE B.V.

Asterweg 17 A6, 1031 HL Amsterdam, The Netherlands  
Tel: 31-20-820-2175 Fax: 31-20-820-2176 [info@ikeuchieurope.com](mailto:info@ikeuchieurope.com) <http://www.ikeuchieurope.com/>

### IKEUCHI TAIWAN CO., LTD.

11 F-1, No.27, Sec.1, Chung Shan N. Rd., Taipei, 10441 Taiwan, R.O.C.  
Tel: 886-2-2511-6289 Fax: 886-2-2541-6392 [sales@ikeuchi.com.tw](mailto:sales@ikeuchi.com.tw) <http://www.ikeuchi.com.tw/>

### PT. IKEUCHI INDONESIA

Ruko Easton Jalan Gunung Pandeman Blok E No.9, Lippo Cikarang Kel. Cibatu Kec., Cikarang Selatan Bekasi 17550 Indonesia  
Tel: 62-21-2909-3246 Fax: 62-21-2909-3247 [sales@ikeuchi.co.id](mailto:sales@ikeuchi.co.id) <http://www.kirinoikeuchi.co.jp/ijk/>