

Convex Round Inlet Solid Stream Jet

CCRP CRP(AL99)

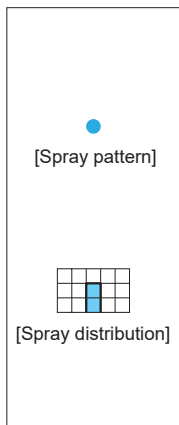
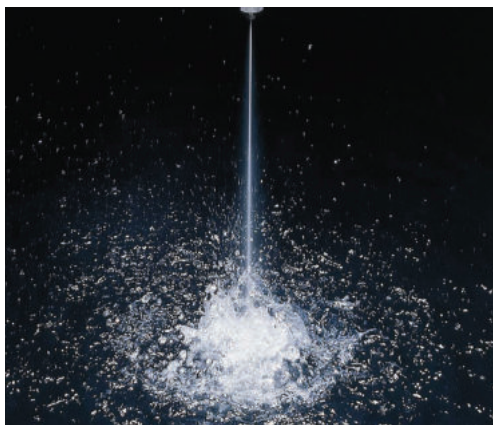

[Features]

- Convex round inlet protrudes inside the pipe to prevent particles from flowing into the nozzle, reducing clogging.
- CRP (AL99) series features high-purity alumina ceramic orifice providing stable performance with longer life.
- Short water path design enables easy and thorough brush-cleaning.

[Standard pressure]

2 MPa

[Applications]

Cleaning: Wire and felt parts of papermaking machines, machinery, parts, vehicles, returnable containers, bottles

Solid Stream

CCRP series

CCRP series (All metal)					
Structure	• Made of metal, one-piece structure.				
Material	• S303				
Pipe conn. size	Dimensions (mm)				Mass (g)
	L1	L2	H	N	
R1/8	18.5	5.5	12	6	8.5
R1/4	22.5	7	14	7.5	17

[Note] Appearance and dimensions may differ slightly depending on materials and nozzle codes.

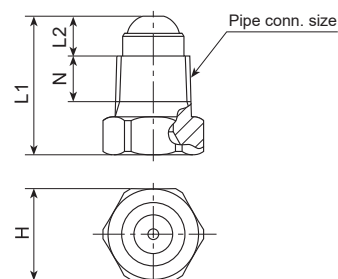

CRP (AL99) series

CRP (AL99) series (with alumina ceramic orifice inserted)					
Structure	• One-piece structure with high-purity alumina orifice inserted.				
Material	• Nozzle orifice: 99% alumina • Nozzle body: S303				
Pipe conn. size	Dimensions (mm)				Mass (g)
	L1	L2	H	N	
R1/8	18	5	12	6	7
R1/4	22	6.5	14	7.5	15

[Note] Appearance and dimensions may differ slightly depending on materials and nozzle codes.

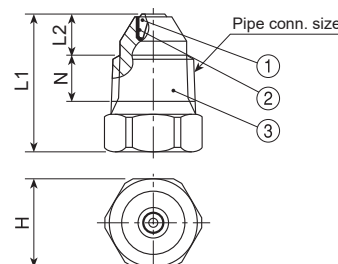

① Ceramic orifice (99% Alumina)
② Adhesive: Araldite® ③ Nozzle body

Orifice diameter code	Pipe connection size				Spray capacity (ℓ/min)					
	CCRP		CRP (AL99)		0.3 MPa	0.5 MPa	0.7 MPa	1 MPa	2 MPa	3 MPa
	R1/8	R1/4	R1/8	R1/4						
ø0.5	○	○	○	○	0.20	0.26	0.31	0.37	0.52	0.63
ø0.6	○	○	○	○	0.29	0.37	0.44	0.53	0.74	0.91
ø0.7	○	○	○	○	0.39	0.51	0.60	0.72	1.01	1.24
ø0.8	○	○	○	○	0.51	0.66	0.78	0.94	1.32	1.62
ø0.9	○	○	○	○	0.65	0.84	0.99	1.18	1.67	2.05
ø1.0	○	○	○	○	0.80	1.03	1.22	1.46	2.07	2.53
ø1.1	○	○	○	○	0.97	1.25	1.48	1.77	2.50	3.06
ø1.2	○	○	○	○	1.15	1.49	1.76	2.10	2.98	3.64
ø1.3	○	○	○	○	1.35	1.75	2.07	2.47	3.49	4.28
ø1.4	○	○	○	○	1.57	2.02	2.40	2.86	4.05	4.96
ø1.5	○	○	○	○	1.80	2.32	2.75	3.29	4.65	5.69
ø1.7	○	○	○	○	2.31	2.99	3.53	4.22	5.97	7.31
ø2.0	○	○	○	○	3.20	4.13	4.89	5.84	8.26	10.1

[Note] The above nozzles are manufactured for specific orifice diameters, therefore spray capacity is not guaranteed.

How to order

Please inquire or order for a specific nozzle using this coding system.

<Example> 1/8M CRP ø0.6 AL99-S303

Pipe conn. size*	Series	Orifice diameter code	Material
1/8M	CRP	ø0.5	AL99-S303: CRP series
1/4M	CCRP	}	S303: CCRP series
		ø2.0	

**M" indicates male thread ("R" of the ISO standard) and "F" indicates female thread ("Rc" of the ISO standard), e.g. 1/8M = R1/8.